

Rohnson[®]

INNOVATE FOR LIFE

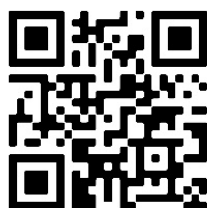

Thank you for buying a Rohson cordless stick vacuum cleaner with digital brushless motor (BLDC)



MAMBA plus

** Scan with your phone or QR reader to find out more about your machine

SAFETY INSTRUCTIONS

The vacuum cleaner is specially used for household purpose, please do not use it for commercial or other purposes.

1. Please don't use the vacuum cleaner to suck detergent, kerosene, glass waste, needles, cigarette ash, moisturized dust, sewage, matches, similar articles or any liquid.
2. Please do not use the vacuum cleaner to suck cement, gypsum powder, wall power and similar small particles, or toy, paper filler and other larger objects, which can cause vacuum cleaner clogging, motor burnout and another fault.
3. Please do not use the vacuum cleaner near fire source and other high temperature places.
4. When the vacuum cleaner is used, please pay attention to install HEPA and rolling brush properly before operating the unit.
5. When the vacuum cleaner is used, please note that the suction inlet cannot be clogged and rolling brush cannot be blocked, otherwise motor failure may be caused.
6. Please do not dump or splash water or other liquid into the machine, to avoid short-circuit and burn-out of machine.
7. When cleaning the vacuum cleaner filters, please remove and wash them with water **if recommended by the manufacturer**; when you need to use them, please install the dried filters into the vacuum cleaner. Do not use the wet filters, otherwise it may burn out the machine due to the short-circuit.
8. Please use dry cloth for cleaning vacuum cleaner, do not use gasoline, banana oil etc. otherwise shell cracking or fading will be caused. Please do not use and store the machine in extremely adverse conditions, such as extreme temperature. Use the vacuum cleaner in room temperature of 5°C~ 40°C. Please store it in a cool and dry place. Sunlight exposure for long time should be prohibited.
9. Make sure that the mains voltage matches the voltage stated on the rating label of the appliance and that the outlet is grounded.
10. Do not use the device if it has been dropped or if there are any visible signs of damage.
11. Do not try to repair the appliance by yourself. Contact our official technical support service.
12. Do not use any accessory that has not been recommended by the manufacturer, as they might cause injuries or damage.
13. Turn off and unplug the appliance from the mains supply when it is not going to be used for a long period of time, before cleaning or repairing, before attaching components and before removing the battery.
14. Never modify the charger in any way.
15. Do not use any battery that has not been provided with the original product.
16. The appliance is not intended to be used by children under the age of 12. It can be used by children over the age of 12, as long as they are given continuous supervision.
17. This appliance is not intended to be used by persons with reduced physical, sensory or mental capabilities or lack of experience or knowledge unless they have been given supervision or instruction concerning the use of the appliance in a safe way by a person responsible for their safety and understand the hazards involved.
18. Supervise young children to make sure that they do not play with the appliance. Close supervision is necessary when the appliance is being used by or near children.

BATTERY INSTRUCTIONS

-This appliance includes Li-ion batteries, do not incinerate or expose them to high temperature, as they may explode.

-Leaks from the battery or battery cells can occur under extreme conditions. Do not touch any liquid that leaks from the battery. If the liquid gets into contact with skin, wash immediately with soap and water. If the liquid gets into the eyes, flush them immediately with clean water for a minimum of 10 minutes and seek medical attention. Wear gloves to handle the battery and dispose of immediately in accordance with local regulations.

-Avoid contact between the battery and small metallic objects such as paper clips, coins, keys, nails or screws.

-Before a new battery is used or the battery is used for the first time after long-term storage, fully charge the battery. When the device is stored and not used for long periods of time, ensure that the battery pack is fully charged and ensure that the battery is charged and discharged at least once every three months.

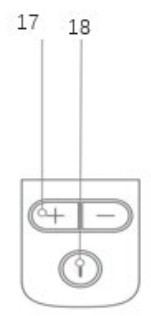
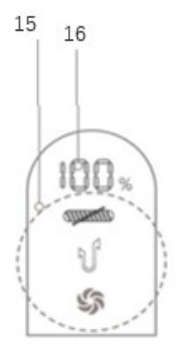
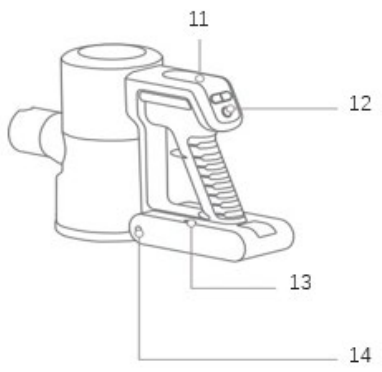
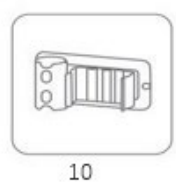
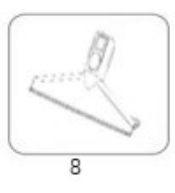
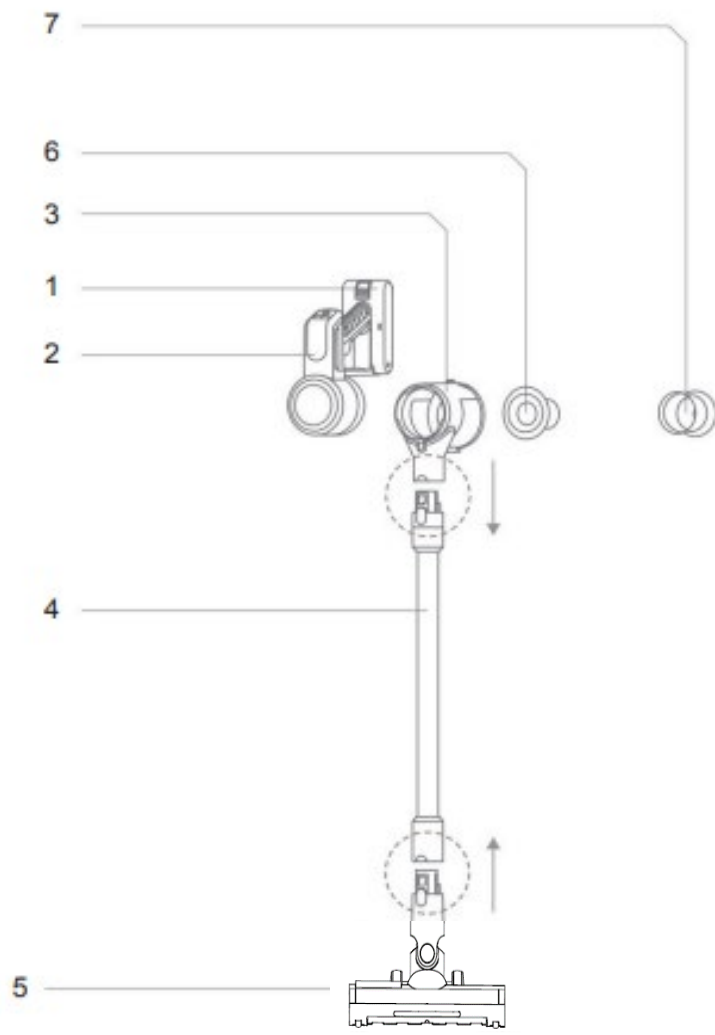

DIAGRAMS REVISED

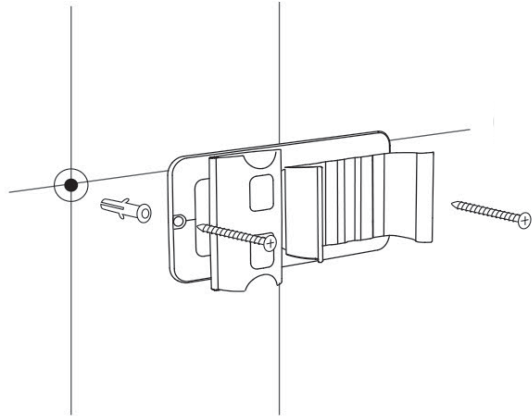

FIG. 1A

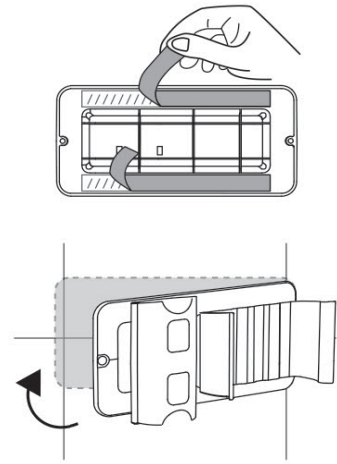

FIG. 1B

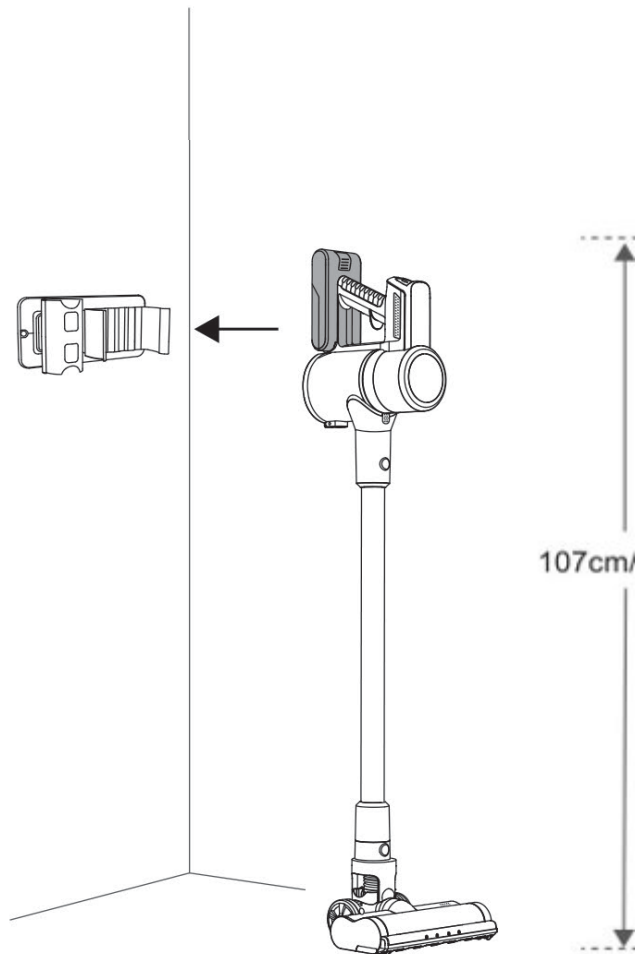

FIG. 2

DIAGRAMS REVISED

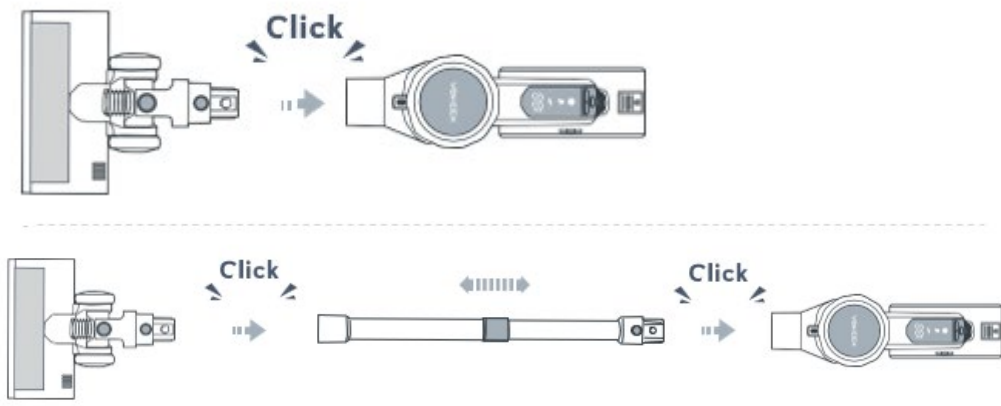

FIG. 3

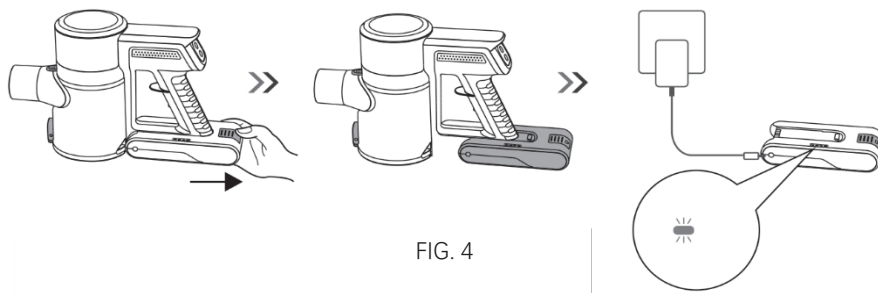

FIG. 4

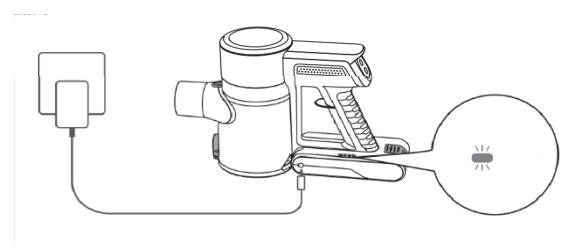

FIG. 5

DIAGRAMS REVISED

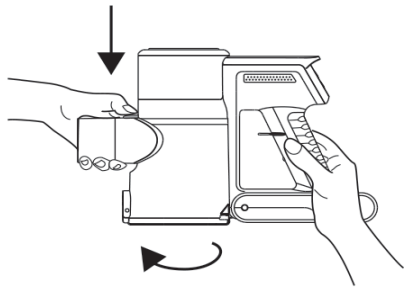

FIG. 8

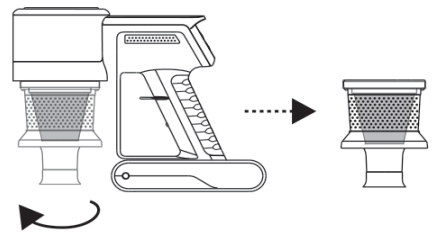

FIG. 9

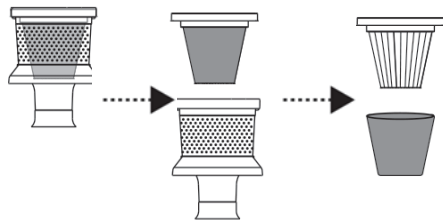

FIG. 10A

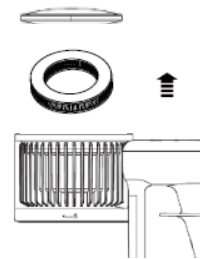

FIG. 10B



FIG. 11

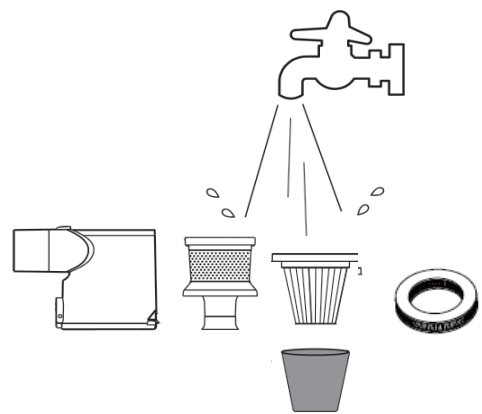

FIG 12

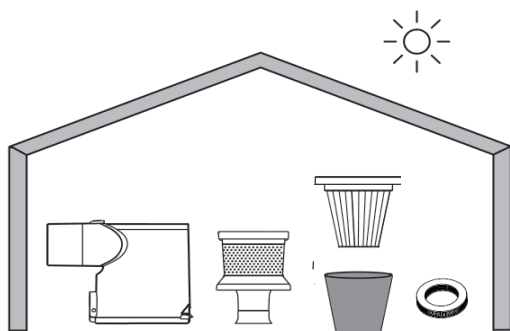

FIG 13

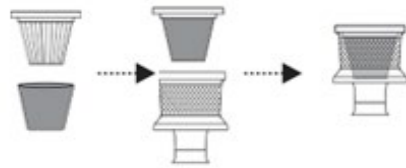
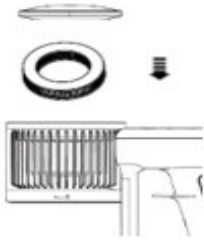

FIG. 14

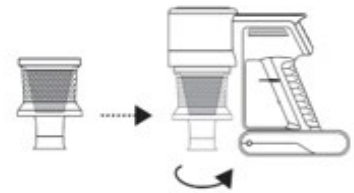

FIG. 15



FIG. 16

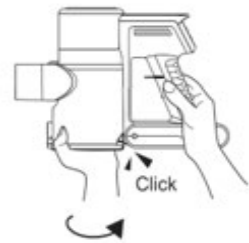

FIG. 17

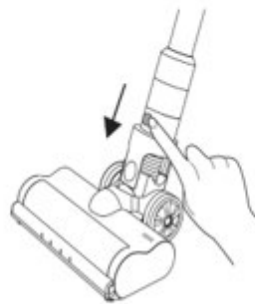

FIG. 18

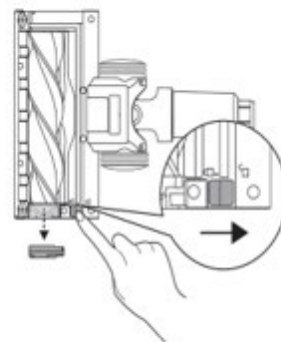

FIG. 19

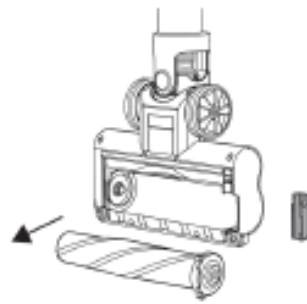

FIG. 20

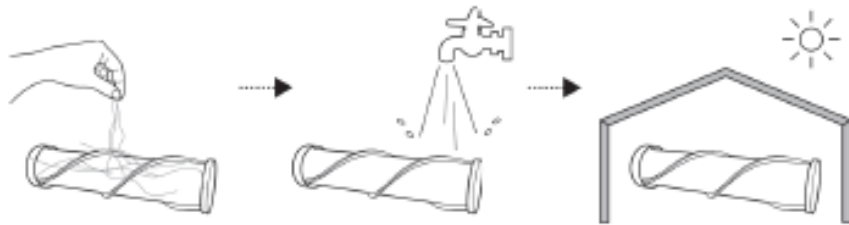

FIG. 21

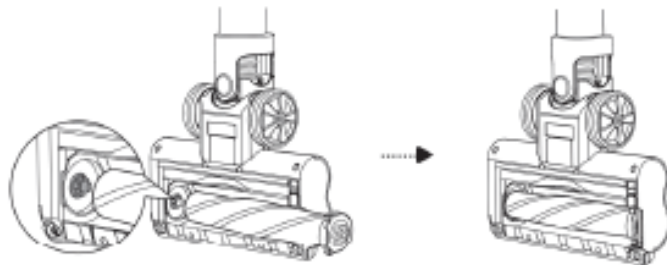

FIG. 22

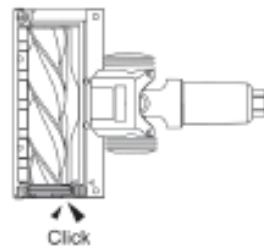

FIG. 23

PRODUCT COMPONENTS

DESCRIPTION

1. Battery pack
2. Main body
3. Dust container
4. Metal tube
5. Power brush
6. HEPA filter
7. Metal filter
8. **Sofa brush (diagram has changed)**
9. Crevice tool
10. Wall mount
19. Bristle roller
20. Soft roller
21. **Mini turbine (diagram has changed)**
11. LED screen
12. Control buttons
13. Charging indication light
14. Charging socket
15. Indication for power level
16. Indication of instant energy volume
17. Power level +/-
18. ON/OFF button

Note!

Accessories may work onto tube or main machine.

INSTRUCTION OF USE

WALL MOUNTING

The vacuum cannot stand on its own. Make sure it is mounted securely.

Attach the handle as shown in Fig. 1A or Fig.1B (Do not stick to rough or uneven surface like brick, porous aluminum or stucco surfaces.)

Attach the bracket at the height of 107cm (Fig. 2)

ASSEMBLING

Attach your desired cleaning accessory to the metal tube or main unit of the vacuum as illustrated (FIG.3)

OPERATION METHOD

Press the On/off button to power on or power off this vacuum cleaner.

You can choose between the different suction power by switching buttons '+' & '-' on the top of the handle: press button '+' to increase vacuum suction, press button '-' to decrease vacuum suction.

The selected suction power  lights up on the display.

a. Green is for low (runtime up to 50 min)

b. Blue is for medium (runtime up to 25 min)

c. Red is for high (runtime up to 12 min)

CHARGING THE BATTERY

The vacuum is powered by the built-in lithium battery. Before first use, charge the battery for at least 3,5hours.

You can charge the battery in two ways. Method 1 (FIG.4), method 2 (FIG.5) Notes:

The vacuum cannot work while charging

The power indicator(s) is(are) flashing during charging and stay white when fully charged.

The power indicators flash when the battery is low

The vacuum cannot be charged when the ambient temperature is below 10°C/50°F or above 45°C/113°F

CLEANING AND MAINTENANCE

When the filter is blocked due to excessive dust, it must be cleaned and if necessary, it can also be replaced. To ensure maximum efficiency, it is suggested to clean the filter regularly (at least twice a month) and to replace the filter at least once a year. Both cleaning and replacement depend on use. More frequent cleaning may be required when vacuuming fine dust or using the machine intensively.

Clean the dust box and filters

Caution! Turn off the vacuum before cleaning it.

If the dust box is filled with dust, the vacuum may stop to prevent overheating.

Clean the dust box before it fills to the MAX line.

1. Disassemble the metal tube (FIG.6)
2. Press the dust empty button to empty the dust box (FIG.7)
3. Press and hold the dust box release button and turn the dust clockwise to release it (FIG.8)
4. Turn the metal filter clockwise to release it (FIG.9)
5. Turn the HEPA filter clockwise to release it and remove the sponge filter (FIG.10A)
6. Turn the filter cover anticlockwise to open and remove the sponge filter (FIG.10B)
7. Shake off debris by tapping the filters against your trash container (FIG.11)
8. Wash the filters with cold water only, under a running tap. (FIG.12)

Repeat washing the filter until clean water runs. Do not immerse into water.

9. Tap the filter to remove any excess water and leave to dry completely. Allow the filters to dry completely in a dry area with good air circulation for at least 24 hours, away from direct sunlight, heat sources like heating appliances etc. (FIG.13)

Make sure the filters are completely dry before installing them.

CAUTION:

- Do not clean the filters in a washing machine.
 - Do not use a hair dryer to dry them.
 - Never use the appliance without filters.
10. Install the sponge filter and close with the filter cover.
- Insert the sponge filter on the HEPA filter and turn counter-clockwise to install it in the metal filter (FIG.14)
11. Turn the metal filter counter-clockwise to install it in the main unit. (FIG.15)
 12. Make sure that the grooves on the dust box aligned with the buckles on the main unit and then push the dust box upward into the main unit. (FIG.16)
 13. Turn the dust box counter-clockwise until you hear a click (FIG.17)



Clean the rolling brush

1. Turn off the vacuum, press the floor brush release button to remove the floor brush from the metal tube (FIG.18)
2. Press the rolling brush release button to release the rolling brush locking strip. (FIG.19)
3. Take out the rolling brush locking strip and lift the rolling brush to remove. (FIG.20)
4. Clean the rolling brush using scissors or other tools, rinse and then air-dry the rolling brush (FIG.21)
5. Reinstall the rolling brush by inserting the fixed protruding end first, then clicking into place. (FIG.22)
6. Push the rolling brush locking strip in until you hear a click (FIG.23)

TROUBLESHOOTING

Switch off the appliance and disconnect the mains plug before addressing any faults!

Failure to do so may result in injury or electric shock.

Problem	Possible causes	Solution
Appliance is not working	Battery is empty	Charge the battery
	Brush roller is blocked	Clean the brush roller and remove debris such as hair and fibres if necessary.
Battery will not charge	Appliance or charging station is not correctly connected to a power socket	Connect the mains adaptor correctly to a functioning power socket
	Contact with charging station has not been established	Hang the hand-held appliance correctly in the charging station
Suction power decreases	Suction opening on the container is blocked	Clean the suction opening on the hand-held appliance and check the suction tube for any dirt.
	Dust container is full	Empty the dust container
	Filters are dirty	Clean the filters, replace the HEPA filter if necessary
	Brush roller is blocked	Clean the brush roller and remove debris such as hair and fibres if necessary.
Vacuum is not picking up debris. No suction or light suction.	Dust box may be full	empty the dust box.
	Check for blockages	Clear crevice tool nozzle and floor brush from blockages; remove any string, hair etc that may be wrapped around the rolling brush Clear connection between the main unit and metal tube from blockages Clear any debris from metal tube
	Check filters to see if they need cleaning.	Follow instructions for rinsing and completely air-drying the filters before reassembling.
Vacuum turns off on its own.	Battery is low	Check the battery indicator lights and recharge if needed.
	Check for blockages	Empty the dust box and clean the filters. Check the metal tube, accessories and openings and remove any blockages.
	Machine is overheated	Allow the main unit of the vacuum to cool for at least for 4 minutes and restart the vacuum
Filter cannot be inserted correctly	Filter not fitting properly in slot	Check filter and fitting are correct
	Brush roller not inserted correctly/blocked or Flashes red 6 times	Check that the brush roller is correctly fitted and remove any string, carpet fibers or hair that may be wrapped around the rolling brush
	Suction blocked or Flashes red 6 times	Check the brush rollers, suction tube and suction opening for dirt/blockages

TECHNICAL SPECIFICATIONS:**MODEL:** Rohnson mamba plus M2**BATTERY:** Li-Ion 25,9V 2200mAh, 7 battery cells**POWER:** 315W**DIGITAL MOTOR (BLDC motor)**

IMPORTANT INFORMATION FOR CORRECT DISPOSAL OF THE PRODUCT IN ACCORDANCE WITH EC DIRECTIVE 2002/96/EC.

At the end of its working life, the product must not be disposed of as urban waste. It must be taken to a special local authority differentiated waste collection center or to a dealer providing this service. Disposing of a household appliance separately avoids possible negative consequences for the environment and health, deriving from inappropriate disposal and enables the constituent materials to be recovered to obtain significant savings in energy and resources. As a reminder of the need to dispose of household appliances separately, the product is marked with a crossed-out wheeled dustbin.