

Rohnson[®]

Stand fan 40cm with remote control

Model: R-869

Instruction Manual



**PLEASE READ ALL INSTRUCTIONS CAREFULLY AND
RETAIN FOR FUTURE USE**

INSTRUCTIONS FOR USE

Dear Customer,

In order to avoid damage due to incorrect use, please read these Instructions for Use through carefully before connecting your device to the mains.

Please pay particular attention to the safety information. If you pass the device on to a third party, these Instructions for Use must also be handed over.

SAFETY WARNINGS

CAUTION

Incorrect operation and improper use can damage the appliance and cause injury to the user. The appliance must only be used for its intended purpose. No responsibility can be taken for any damage caused through incorrect use or improper handling.

Before connecting the appliance to a power source, check that the current and power of the source match those specified on the rating label.

Do not put the appliance or the plug-in water or any other liquid. If the appliance accidentally falls into water, make sure your hands are dry then unplug the appliance immediately. Only discard the appliance if it is safe to do so.

Never attempt to open the housing yourself.

Do not insert any kind of object into the housing.

Do not use the appliance with wet hands or on a damp floor or when the appliance itself is wet. Do not touch the plug with wet or damp hands.

Check the power cable and the plug regularly for any possible damage. If the power cable or plug is damaged, it must be replaced by the manufacturer or a qualified person to avoid creating a hazardous situation.

Do not use the appliance if it is dropped or otherwise

damaged, or if the power cable or plug are damaged.

If the appliance is damaged, take it to the authorized service center for examination and if necessary repair.

Never attempt to repair the appliance yourself. Doing so could cause an electric shock.

Do not allow the power cable to hang over edges. Also keep the power cable well away from hot objects and naked flames. Only ever remove the plug from the mains socket by holding the plug itself.

Make sure there is no danger of the power cable or an extension cable being inadvertently pulled or causing anyone to trip when the appliance is in use.

If an extension cable is used, it must be suited to the power consumption of the appliance, otherwise overheating of the extension cable and/or plug may occur.

This appliance is not suitable for commercial use nor for use in the open air. Never leave the appliance unattended while it is in use.

If the supply cable is damaged, it must be replaced by the manufacturer, its service agent or similarly qualified persons in order to avoid a hazard.

Ensure that the fan is disconnected from the mains supply before removing the guard.

ATTENTION:

Children cannot recognize the dangers associated with incorrect use of electrical appliances So, never allow children to use household appliances without supervision. Always remove the plug from the mains socket when the appliance is not in use and before each occasion when it is cleaned.

Danger! Nominal voltage is still present in the appliance as long as the appliance is connected to the mains socket.

Switch the appliance off before disconnecting it from the mains.

Never use the power cable to carry the appliance. Use handles to carry the appliance.

Ensure that the mains socket where you plug your fan in corresponds to the voltage specified on the rating label on the base of the appliance.

This appliance can be used by children aged 8 years and above and persons with reduced physical, sensory or mental capabilities or a lack of experience and knowledge if they have been

given supervision or instruction concerning safe use of the appliance and understand the hazards involved.

Children must not play with the appliance.

Cleaning and user maintenance must not be carried out by children without supervision.

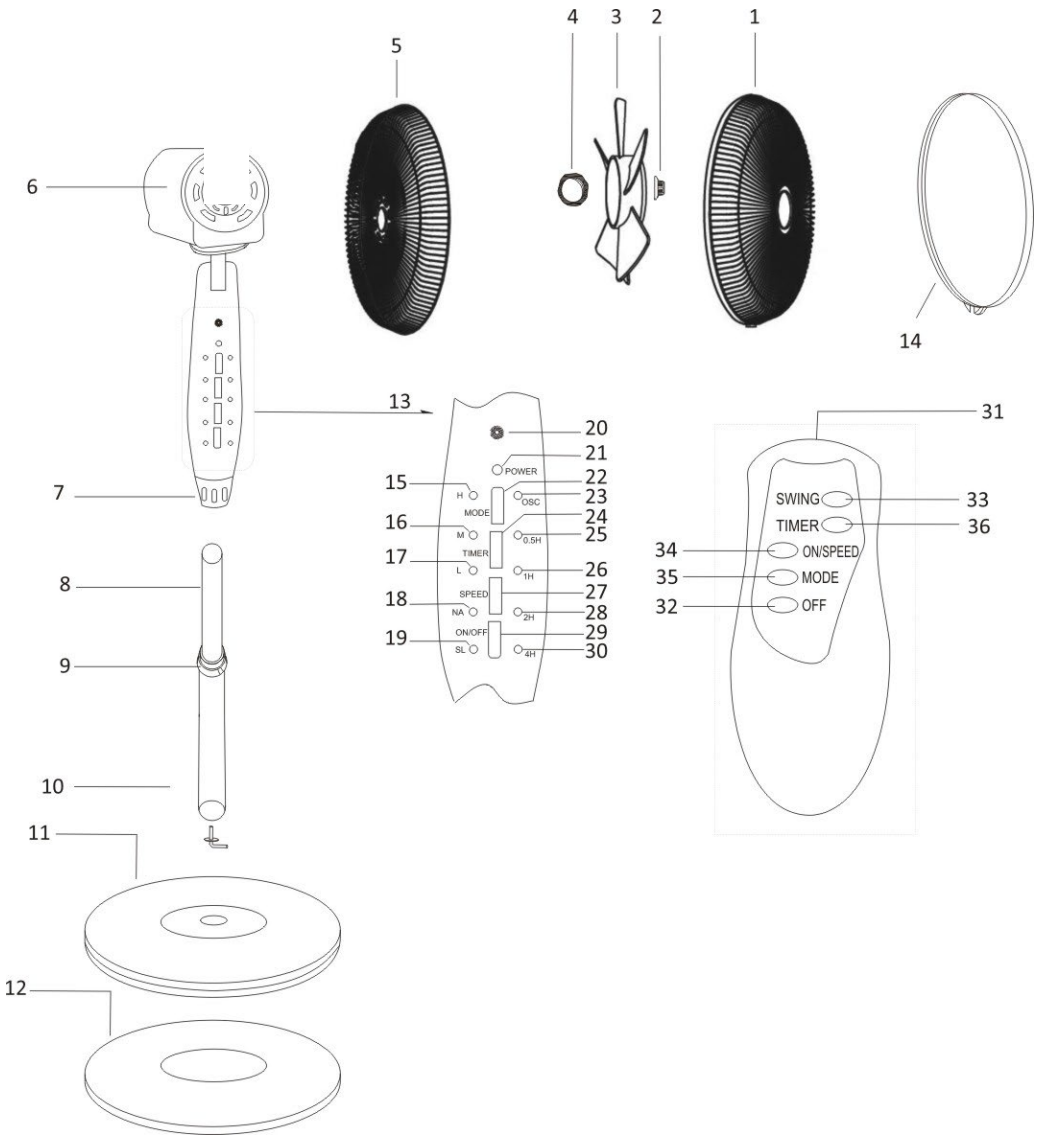

DESCRIPTION OF PARTS

1. Front Grill
2. Blade fastener
3. Blade
4. Rear Grill fastener
5. Rear grill
6. Motor housing
7. Extension pole tighten ring
8. Adjustable pole inner tube
9. Height adjustment ring
10. Adjustable pole outer tube
11. Round Base
12. Heavy Plate
13. Control panel
14. Guard Hoop with the screw
15. High speed indicator
16. Medium speed indicator
17. Low speed indicator
18. NA (Natural wind) indicator
19. SL (Sleep) indicator
20. Remote sensor
21. Power indicator
22. Mode button

Note: Mode button if keep on press long to 3 seconds, OSC function will activate,

When click button is mode function,

When press button long to 3 seconds could change to OSC function

23. OSC (Oscillation) indicator
24. Timer button
25. Timer 0.5hr indicator
26. Timer 1hr indicator
27. Speed button
28. Timer 2hr indicator
29. ON/OFF button
30. Timer 4hr indicator
31. Remote control transmitter / receiver

32. OFF button

33. SWING (Oscillation button)

34. ON/ Speed button

35. Mode button

36. Timer button

ASSEMBLY INSTRUCTIONS

1. Place the round base (11) with heavy plate (12) on dry, flat surface
2. Release the adjustable pole inner tube (8) by loosening the height adjustment ring (9).
3. Attach the adjustable pole (8,9,10) to the round base (11,12) by hook-shaped screw and washer.
4. Attach the control panel (13) to the adjustable pole inner tube (8) by tightening the ring (9)
5. Unscrew the rear grill fastener (4) by rotating it anticlockwise
6. Position the rear grill (5) against the front of the motor with its handle at the top, ensuring that the locating pedes on the motor are correctly inserted into the hole on the grill
7. Screw the grill fastener (4) onto the projecting thread on the motor front cover by rotating it clockwise until it is firmly tightened.
8. Push the fan blade (3) onto the motor shaft. Then firmly screw on the blade fastener (2).
9. Attach the front grill (1) to the rear grill (5) with plastic guard hoop (14) and tighten the screw on firmly, then slightly adjust the front grill to let the logo upright to the center position.

OPERATION

1. Place your fan on an even, dry and stable surface.
2. Ensure the fan is set to 0 (OFF) before plugging it into a power socket.
3. Make sure your local voltage matches the technical data of the appliance. Otherwise the appliance may overheat and get damaged.

4. Switch on the appliance by pressing ON/OFF button on the unit or **ON/ Speed button** on the remote control.

5. Press mode button to switch between normal, natural wind (NA), sleep mode (SL).

Note: Corresponding indicator will light up.

6. Press speed button to switch the fan speed between low (L) / Medium (M) / High (H).

Note: Corresponding indicator will light up.

7. Press timer button continuously to preset auto switch off timer.

Indicator light up according to the desire timer Count down timer up to 7.5hrs with indicator light on the control panel.

Important: Remote control transmitter / receiver (31) for infrared transmission to the device, so need to toward the Remote sensor (20) in all operating modes.

ADJUST TILT ANGLE

To adjust the desired fan angle, tilt the motor housing up or down until it clicks into place.

OSCILLATION

Changing the direction of the air current!

-Press the OSC button on remote control, to start/stop the oscillation mode.
Or Press Mode button to keep on press long to 3 seconds to start/stop the oscillation mode by press long Mode button.

CLEANING AND CARE

Before cleaning, always switch off the appliance and disconnect it from the mains.

Never immerse the appliance in water. Danger! Electric Shock!

-Clean the appliance using a a soft damp cloth.

-Never spray the appliance with liquids or submerge it in water or other liquid.

-For cleaning purpose, front and back grill as well as the fan blade can be removed.

After the cleaning process is finished make sure that all parts are dry and that the front/ back grill incl. fan blade are properly reassembled.

Never use alcohol, gasoline, and/or any other aggressive cleaning agents/hard objects.

CAUTION: The Fan Blade may have sharp edges. Handle with extreme care.

STORAGE

Keep the appliance away from children and store it in a clean and dry place, best in its original box or cover it to protect it from dust.



IMPORTANT INFORMATION FOR CORRECT DISPOSAL OF THE PRODUCT IN ACCORDANCE WITH EC DIRECTIVE 2002/96/EC.

At the end of its working life, the product must not be disposed of as urban waste. It must be taken to a special local authority differentiated waste collection centre or to a dealer providing this service. Disposing of a household appliance separately avoids possible negative consequences for the environment and health, deriving from inappropriate disposal and enables the constituent materials to be recovered to obtain significant savings in energy and resources. As a reminder of the need to dispose of household appliances separately, the product is marked with a crossed-out wheeled dustbin.